

DAWSONS-TECH[®]

OVER 35 YEARS OF EXPERIENCE

STAINLESS STEEL PRESSURE GUGE COCK & ACCESSORIES

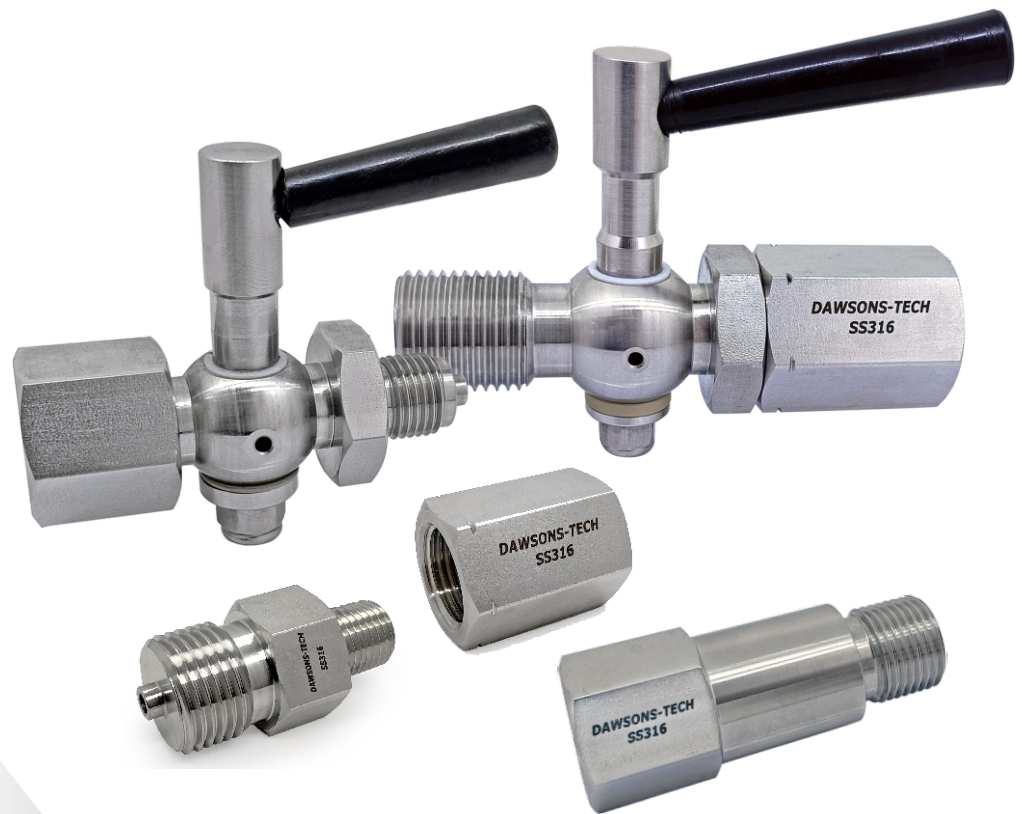

***Most Cost Effective, World Class Quality
Flow Control Components for Wide Range
of Industries and Applications***

THE COMPANY

DAWSONS-TECH is an ISO 9001:2015 certified manufacturing company offers wide range of **Consistent and Reliable World Class Quality Flow Control Components** used in Fluid / Gas Control systems in a wide range of Industries.

MANUFACTURING :

DAWSONS-TECH established its comprehensive state of art manufacturing and testing facility installing various CNC Turning Centre and CNC Turnmill Centre, Vertical Machining Centre, etc. with the highly motivated and dedicated team of employees in place. This facilitate us to design and manufacture our product range under stringent quality checks and measurements that ensures **“A TOTAL CUSTOMER SATISFACTIONS WITH ZERO DEFECT PRODUCTS”**.

QUALITY :

DAWSONS-TECH pursues not only performance of its products but also ensures **“TOTAL QUALITY CONTROL MANAGEMENT SYSTEMS IN ACCORDANCE TO ISO 9001:2015”** which is achieved by alerting and educating each and every employee, the importance of quality and by implementing the quality control procedures at every stage of production to final inspection from incoming raw material to finish products.

		
OUR CAPABILITIES	CERTIFICATIONS	DEMAND IN INDUSTRIES
<ul style="list-style-type: none"> • Over 35 Years of Experience • Excellent Technical Knowledge • Latest Design Equipment's & Software • Modern Manufacturing Facilities • Highly Motivated Team of Employees • Excellent Inspection Facilities • Product Performance Testing Facilities 	<ul style="list-style-type: none"> • ISO 9001-2015 • PED 2014/68/EU • ASTM F1387-19 • MSS SP-99-2016a • Helium Leak Test • Hydro Static Proof Test • Pneumatic Proof Test 	<ul style="list-style-type: none"> • Original Equipment Manufacturers • Chemical & Petrochemical • Oil & Gas • Power • Compressed Natural Gas (CNG) • Pharmaceutical • Semiconductor
 <div>BENEFITS</div> <ul style="list-style-type: none"> • High Quality • Proven Design for Leak Free Connections • Effective Operations 	<ul style="list-style-type: none"> • High Efficiency • Technical Expertise • Prompt Reply 	<ul style="list-style-type: none"> • Maximum Flexibility • Maximum Safety in Operation • Substantial Cost Saving

RESEARCH & DEVELOPMENT :

With our long experience, expertise and continues Research & Development with incorporation of advanced technology and high-tech cutting-edge machineries, **DAWSONS-TECH** is committed to constant upgradation and expand its product range to meet the requirements of its customer to their entire satisfaction at every time.

CUSTOMER SATISFACTION :

We strive to achieve total customer satisfaction and continuously work to set higher goals to provide the reliable quality, timely delivery of our products and prompt services in the best interest of our customers with very competitive price.

DAWSONS-TECH Pressure Gauge Cock Series : VGC01 & VGC03 are having compact & rugged Bar Stock body design & construction, which is installed between Pressure Gauge and Pipe which is used to isolate the Pressure Gauge from the pressure media in order to inspection or replacement of the Gauge where the pressure is continuously pulsating.

Features / Benefits :

- Replaceable PTFE Packing design.
- 2 Way design.
- Manufactured from Bar Stock.
- Available in Material SS316L.
- Every Gauge cock is Pressure tested.

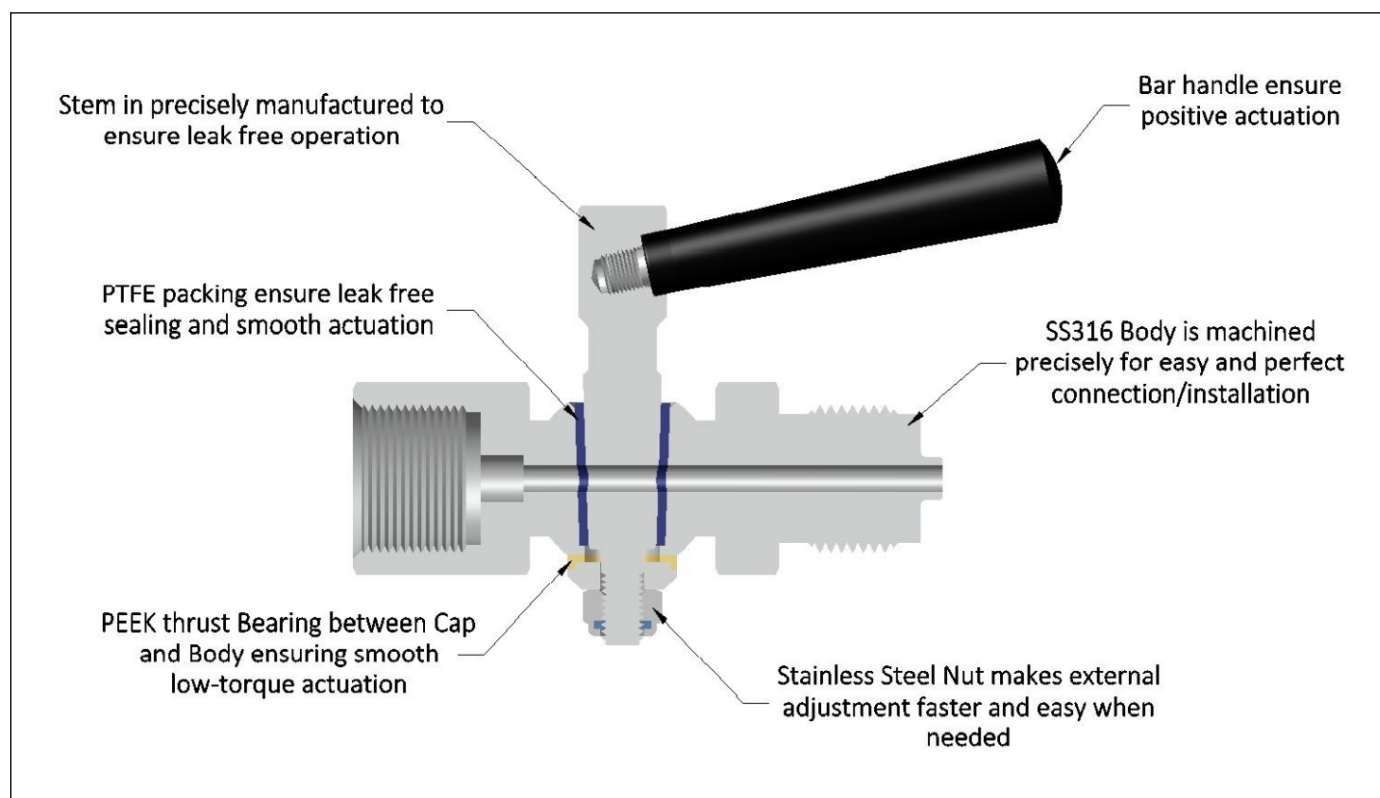
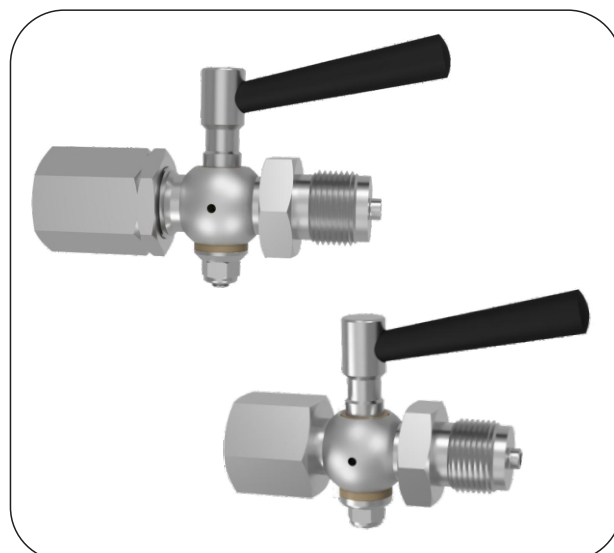

Product Range & Operating Parameters :

- Pressure Rating : 368 PSIG (25 Bar)
- Temperature Rating : 100° C
- End Connections : 1/4" to 1/2" Male / Female
BSP/ BSPT /NPT Pipe Threads
M20 x 1.5 & M20 x 1.5. Metric Threads

Applications :

- Shut-off device for pressure measuring Instrumentations for measurement of Liquid, Gases and Vapours.

Material Of Construction : VGC01

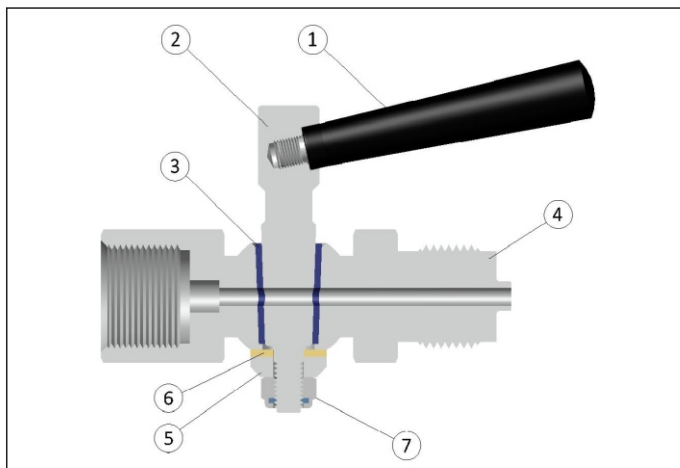

Sr. No.	Description	Material
1	Handle	Phenolic
2	Stem	SS316L
3	Packing	PTFE
4	Body	SS316L
5	Cap	SS316L
6	Thrust Bearing	PEEK
7	Nut	Stainless Steel

Material Of Construction : VGC03

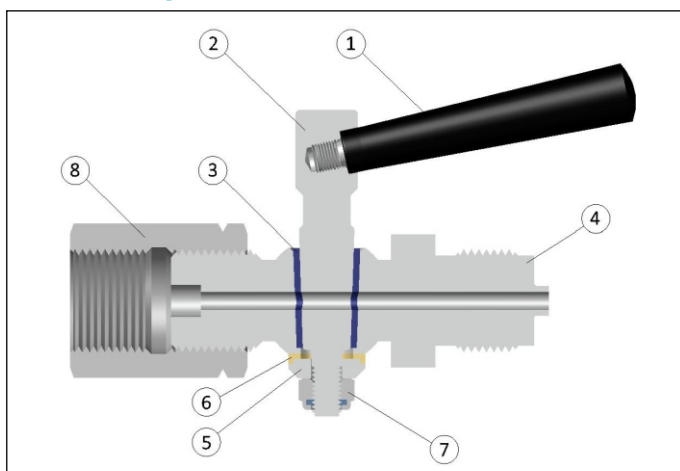

Sr. No.	Description	Material
1	Handle	Phenolic
2	Stem	SS316L
3	Packing	PTFE
4	Body	SS316L
5	Cap	SS316L
6	Thrust Bearing	PEEK
7	Nut	Stainless Steel
8	Swivel Nut	SS316L

Installation :

- The Gauge Cock is to be installed as per approved installation rules of technology. The connection to the pipeline is always on the hexagon side.
- Suitable flat seal has to be installed between the Gauge Cock and the Pressure Gauge.
- As an alternate, the Pressure Gauge can be tightened by screwing into the Gauge Cock with suitable thread sealant.

Operation And Maintenance :

- Switching between the settings "Operation, Venting and Blowing-off" should be as per shown in the illustrations.
- During operations of the Gauge Cock like, operation at low or extreme temperatures, re-adjustment of the Cock may be required to guarantee the tightness.
- Re-adjustment is done by carefully unscrewing the collar Nut Clock with the help of an adjustable spanner.

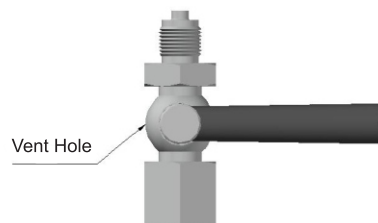

Venting
Pressure gauge
depressurised (zero position)
Supply pipe closed



Operation
Pressure gauge
pressurised
Supply pipe open

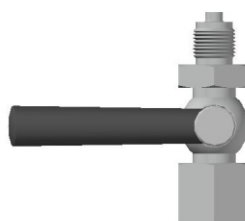

Blowing-off
Pressure gauge isolated
Liquid escapes

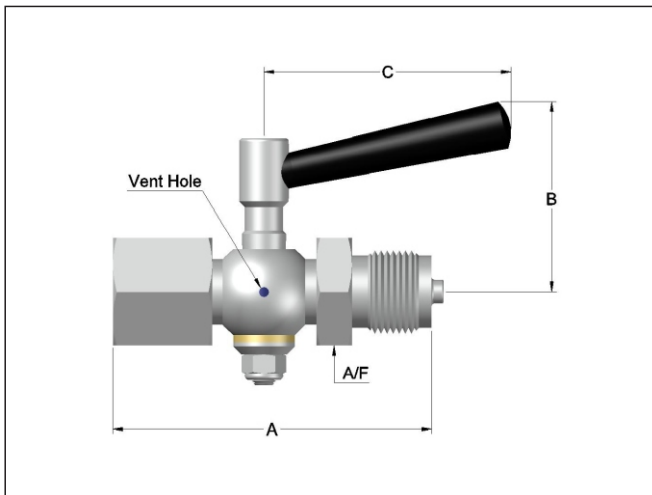

VGC01

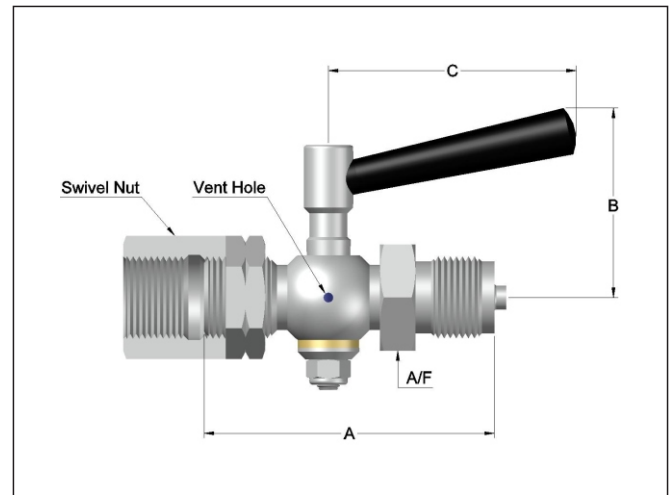

VGC03

STANDARD CONFIGURATION DIMENSIONS

End Connection	Dimensions in mm				Dawsons-Tech Part No.
	A	B	C	A/F	
1/4" BSP (Male x Female)	73.0	47.0	52.0	22.0	VGC01-MF4G
1/2" BSP (Male x Female)	80.0	57.0	64.0	27.0	VGC01-MF8G
1/4" NPT (Male x Female)	73.0	47.0	52.0	22.0	VGC01-MF4N
1/2" NPT (Male x Female)	80.0	57.0	64.0	27.0	VGC01-MF8N
M20 x 1.5 (Male x Female)	80.0	57.0	64.0	27.0	VGC01-MF20M
M22 x 1.5 (Male x Female)	80.0	57.0	64.0	27.0	VGC01-MF22M
1/4" BSP (Female x Female)	70.0	47.0	52.0	22.0	VGC01-FF4RG
1/2" BSP (Female x Female)	80.0	57.0	64.0	27.0	VGC01-FF8RG
1/4" NPT (Female x Female)	70.0	47.0	52.0	22.0	VGC01-FF4N
1/2" NPT (Female x Female)	80.0	57.0	64.0	27.0	VGC01-FF8N
1/4" BSP (Male x Swivel Nut)	55.0	47.0	52.0	22.0	VGC03-MSN4G
1/2" BSP (Male x Swivel Nut)	80.0	57.0	64.0	27.0	VGC03-MSN8G
1/2" BSP x M22 x 1.5 (Male x Swivel Nut)	80.0	57.0	64.0	27.0	VGC03-M8G-22M
M20 x 1.5 (Male x Swivel Nut)	80.0	57.0	64.0	27.0	VGC03-MSN20M
M22 x 1.5 (Male x Swivel Nut)	80.0	57.0	64.0	27.0	VGC03-MSN22M

Note: (1) Gauge Cock with flange are available on request.

(2) Customized Gauge Cock are available on request.

Dimensions are for reference only and subject to change.

PRESSURE GAUGE COCK SERIES : VGC11 & VGC13

DAWSONS-TECH[®]

(Stem with Live Load System)

DAWSONS-TECH Pressure Gauge Cock Series : VGC11 & VGC13 are having compact, rugged & Live Loaded Stem design & construction, which is installed between Pressure Gauge and Pipe which is used to isolate the Pressure Gauge from the pressure media in order to inspection or replacement of the Gauge where the pressure is continuously pulsating.

Features / Benefits :

- Replaceable PTFE Packing design.
- 2 Way design.
- Manufactured from Bar Stock.
- Available in Material SS316L.
- Every Gauge cock is Pressure tested.

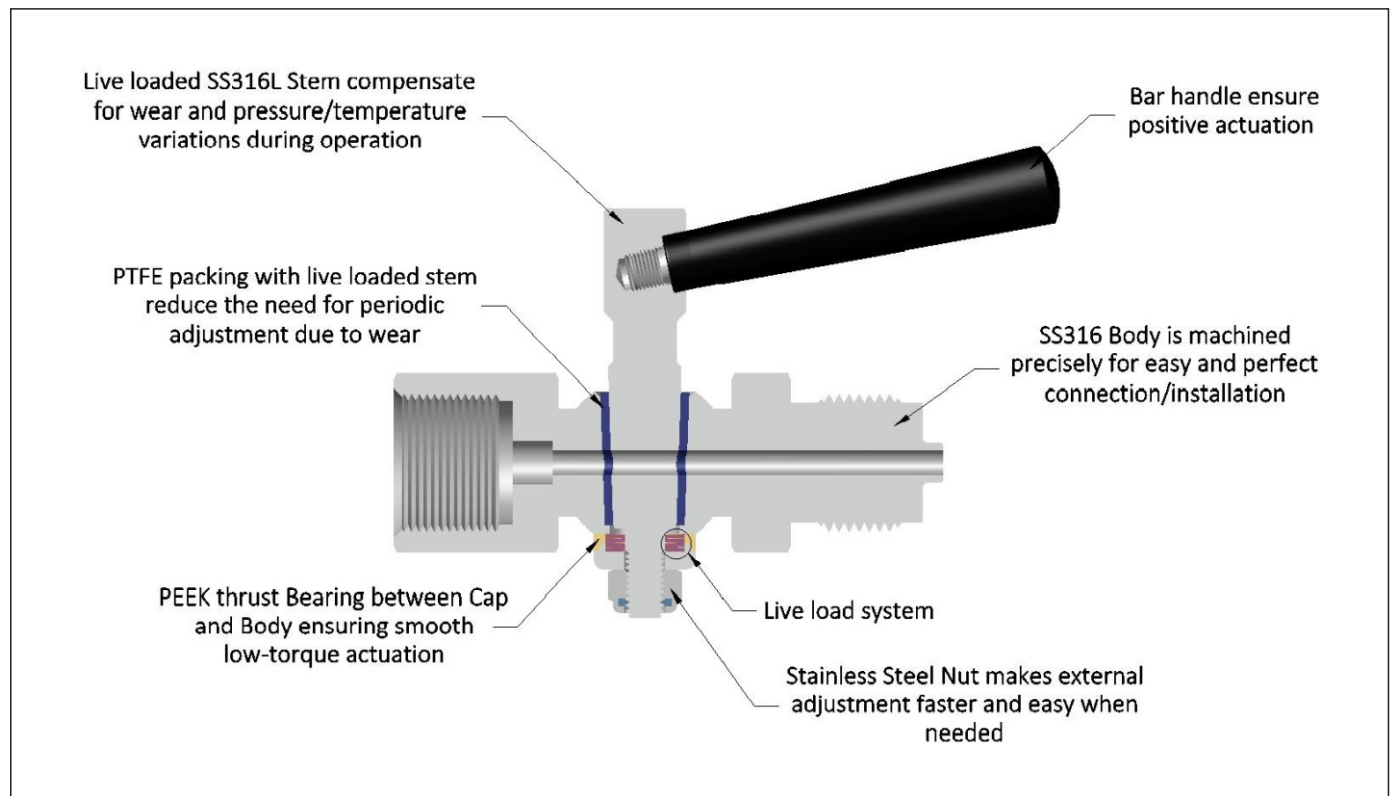

Product Range & Operating Parameters :

- Pressure Rating : 368 PSIG (25 Bar)
- Temperature Rating : 100° C
- End Connections : 1/4" to 1/2" Male / Female
BSP/ BSPT /NPT Pipe Threads
M20 x 1.5 & M20 x 1.5. Metric Threads

Applications :

- Shut-off device for pressure measuring Instrumentations for measurement of Liquid, Gases and Vapours.

PRESSURE GAUGE COCK SERIES : VGC11 & VGC13

(Stem with Live Load System)

Material Of Construction : VGC11

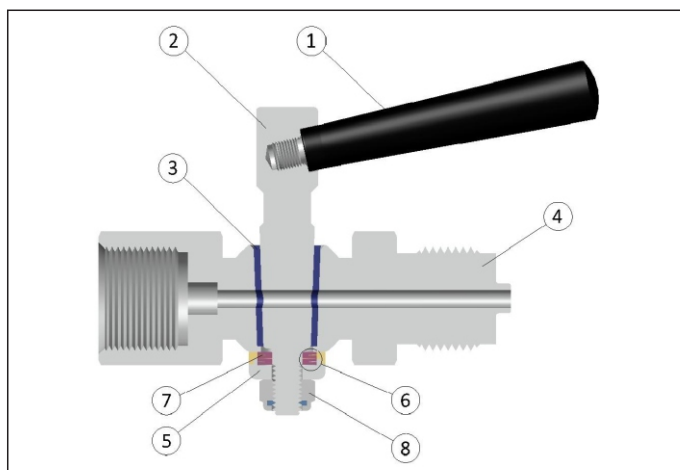

Sr. No.	Description	Material
1	Handle	Phenolic
2	Stem	SS316L
3	Packing	PTFE
4	Body	SS316L
5	Cap	SS316L
6	Spring	Stainless Steel
7	Thrust Bearing	PEEK
8	Nut	Stainless Steel

Material Of Construction : VGC13

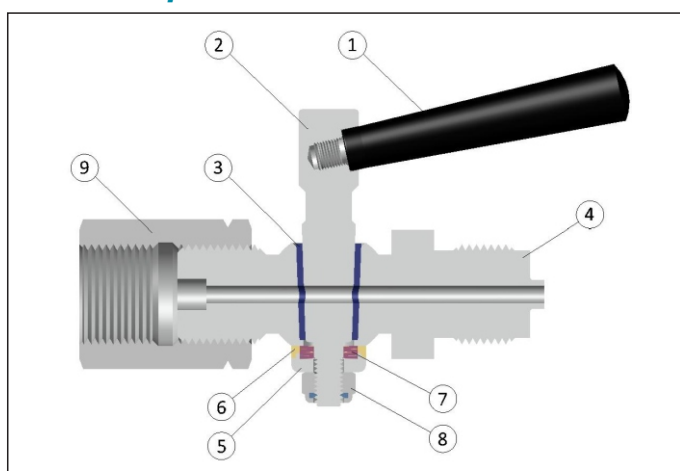

Sr. No.	Description	Material
1	Handle	Phenolic
2	Stem	SS316L
3	Packing	PTFE
4	Body	SS316L
5	Cap	SS316L
6	Thrust Bearing	PEEK
7	Spring	Stainless Steel
8	Nut	Stainless Steel
9	Swivel Nut	SS316L

Installation :

- The Gauge Cock is to be installed as per approved installation rules of technology. The connection to the pipeline is always on the hexagon side.
- Suitable flat seal has to be installed between the Gauge Cock and the Pressure Gauge.
- As an alternate, the Pressure Gauge can be tightened by screwing into the Gauge Cock with suitable thread sealant.

Operation And Maintenance :

- Switching between the settings "Operation, Venting and Blowing-off" should be as per shown in the illustrations.
- With Live Loading Stem in place, there will be no re-adjustment required during its operations at low or extreme temperature. However, if at all required, slight re-adjustment of Cock can be done by carefully screwing the Nut which will re-ensure tightness guarantee.

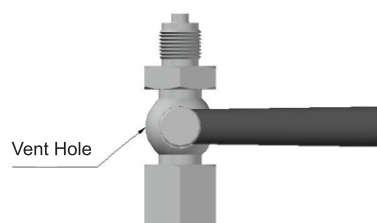

Venting
Pressure gauge
depressurised (zero position)
Supply pipe closed



Operation
Pressure gauge
pressurised
Supply pipe open

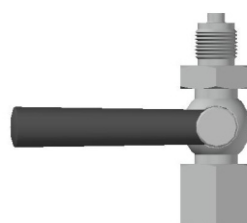

Blowing-off
Pressure gauge isolated
Liquid escapes

(Stem with Live Load System)

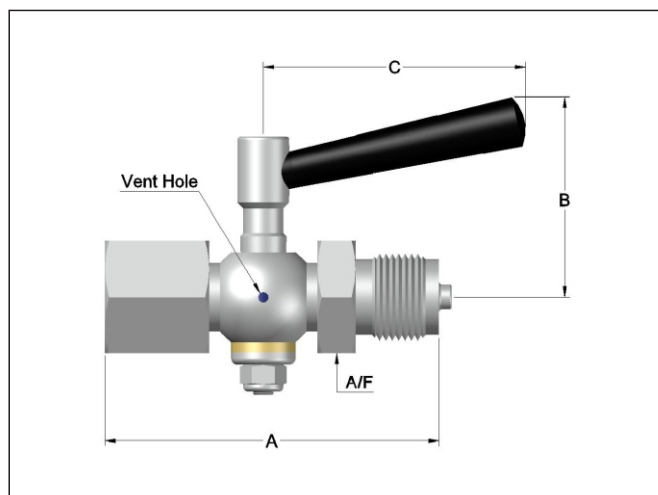

VGC11

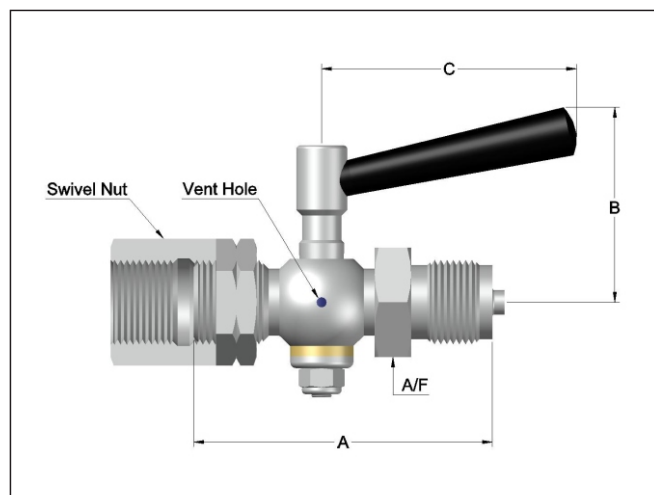

VGC13

STANDARD CONFIGURATION DIMENSIONS

End Connection	Dimensions in mm				Dawsons-Tech Part No.
	A	B	C	A/F	
1/4" BSP (Male x Female)	73.0	47.0	52.0	22.0	VGC11-MF4G
1/2" BSP (Male x Female)	80.0	57.0	64.0	27.0	VGC11-MF8G
1/4" NPT (Male x Female)	73.0	47.0	52.0	22.0	VGC11-MF4N
1/2" NPT (Male x Female)	80.0	57.0	64.0	27.0	VGC11-MF8N
M20 x 1.5 (Male x Female)	80.0	57.0	64.0	27.0	VGC11-MF20M
M22 x 1.5 (Male x Female)	80.0	57.0	64.0	27.0	VGC11-MF22M
1/4" BSP (Female x Female)	70.0	47.0	52.0	22.0	VGC11-FF4RG
1/2" BSP (Female x Female)	80.0	57.0	64.0	27.0	VGC11-FF8RG
1/4" NPT (Female x Female)	70.0	47.0	52.0	22.0	VGC11-FF4N
1/2" NPT (Female x Female)	80.0	57.0	64.0	27.0	VGC11-FF8N
1/4" BSP (Male x Swivel Nut)	55.0	47.0	52.0	22.0	VGC13-MSN4G
1/2" BSP (Male x Swivel Nut)	80.0	57.0	64.0	27.0	VGC13-MSN8G
1/2" BSP x M22 x 1.5 (Male x Swivel Nut)	80.0	57.0	64.0	27.0	VGC13-M8G-22M
M20 x 1.5 (Male x Swivel Nut)	80.0	57.0	64.0	27.0	VGC13-MSN20M
M22 x 1.5 (Male x Swivel Nut)	80.0	57.0	64.0	27.0	VGC13-MSN22M

Note: (1) Gauge Cock with flange are available on request.

(2) Customized Gauge Cock are available on request.

Dimensions are for reference only and subject to change.

ORDERING INFORMATION

For Example : Part No. VGC01-FF8N-SST

Gauge Cock Series	End Connection Type	End Connection Size	Pipe Thread Type	Material	Packing
VGC01	FF	8	N	SSL	P
1	2	3	4	5	6

1) Gauge Cock Series	VGC01
	VGC03
	VGC11
	VGC13

4) Pipe Thread Type	N : NPT
	RT : BSPT
	G : BSP (Male x Female)
	RG : BSP (Female)

2) End Connection Type	FF : Female x Female
	MF : Male x Female
	MSN : Male x Swivel Nut

5) Material	SSL : SS316L
	SST : SS316Ti

3) End Connection Size	Fractional	
	4	1/4"
	6	3/8"
	8	1/2"
	Metric	
	20M	M20 x 1.5
	22M	M22 x 1.5

6) Packing	P : PTFE
------------	-----------------

OUR PLEDGE

DAWSONS-TECH is self-committed for continuous development and upgradation of its products to meet the growing demands for Industries requirements of Flow Control Components by advanced technology induction and cutting-edge solution which is in-line with focused objective mission

"TO PROVIDE OUR CUSTOMERS**WITH****CONSISTENT RELIABLE QUALITY PRODUCTS****AT****RIGHT TIME & COMPETITIVE PRICE"**

Compact Gauge Syphons

DAWSONS-TECH Compact Gauge Syphon is designed and manufactured to be used instead of the Coil Syphon for vertical installations which protects the pressure Gauge from the effect of hot pressure media such as Steam and also reduce the effect of rapid pressure surges. Available in SS316 Material. order to inspection or replacement of the Gauge where the pressure is continuously pulsating.

Pressure Rating : UPTO 6000 PSIG (413 Bar)

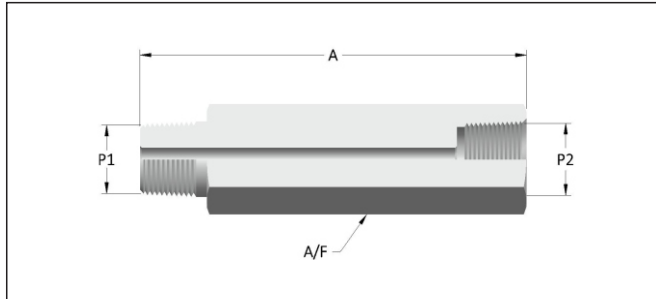

Compact Gauge Syphon

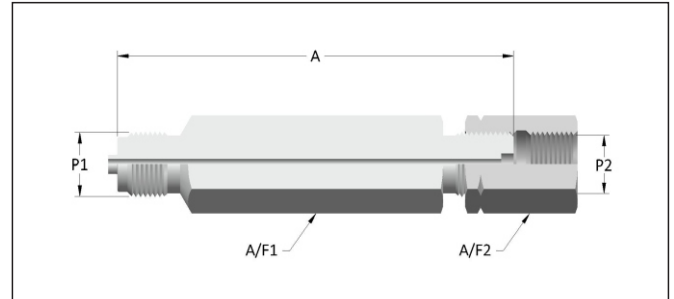

Compact Gauge Syphon (With Swivel Nut)

STANDARD CONFIGURATION DIMENSIONS

End Connection		Dimensions in mm			Dawsons-Tech Part No.
P1	P2	A	A/F1	A/F2	
1/4" BSP (Male)	1/4" BSP (Swivel Nut)	100.0	17.0	19.0	CGS-4G-4SN
1/2" BSP (Male)	1/2" BSP (Swivel Nut)	120.0	27.0	27.0	CGS-8G-8SN
1/4" NPT (Male)	1/4" NPT (Female)	80.0	19.0	-	CGS-4N
1/2" NPT (Male)	1/2" NPT (Female)	110.0	27.0	-	CGS-8N

Dimensions are for reference only and are subject to change.

Swivel Nut

DAWSONS-TECH Swivel Nut is designed according to DIN 16283 having a right-hand thread (RH) on one side and left-hand thread (LH) on the other side to install the parts in any required direction. Available in SS316 Material.

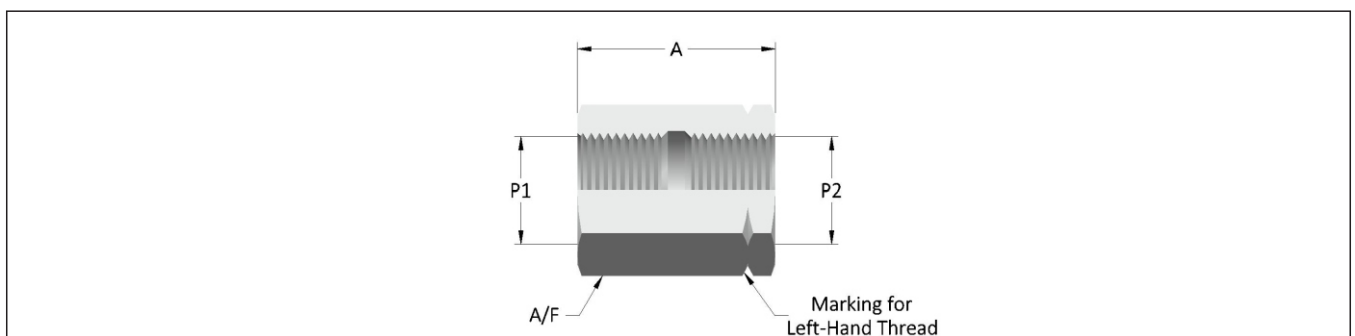

STANDARD CONFIGURATION DIMENSIONS

End Connection		Dimensions in mm		Dawsons-Tech Part No.
P1	P2	A	A/F	
1/4" BSP (RH)	1/4" BSP (LH)	23.0	17.0	SN-4RG
1/2" BSP (RH)	1/2" BSP (LH)	36.0	27.0	SN-8RG
M20 X 1.5 (RH)	M20 X 1.5 (LH)	36.0	27.0	SN-20M
1/2" BSP (RH)	M20 X 1.5 (LH)	36.0	27.0	SN-8G-20M

Dimensions are for reference only and are subject to change.

Gauge Adapter (DIN 16281)

DAWSONS-TECH Gauge Adapter is designed according to DIN 16281. Available in SS316 Material.

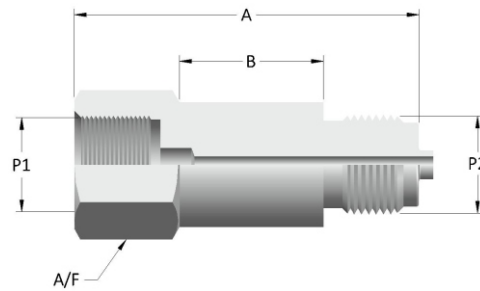

STANDARD CONFIGURATION DIMENSIONS

End Connection		Dimensions in mm			Dawsons-Tech Part No.
P1	P2	A	B	A/F	
1/4" BSP	1/4" BSP	65.0	30.0	19.0	GAC-4RG
1/2" BSP	1/2" BSP	75.0	30.0	27.0	GAC-8RG
1/4" NPT	1/4" NPT	65.0	30.0	19.0	GAC-4N
1/2" NPT	1/2" NPT	75.0	30.0	27.0	GAC-8N

Dimensions are for reference only and are subject to change.

Female to Male Gauge Adapters

DAWSONS-TECH Female to Male Gauge Adapters are designed and manufactured to connect Male and Female thread connection. Available in SS316 Material.

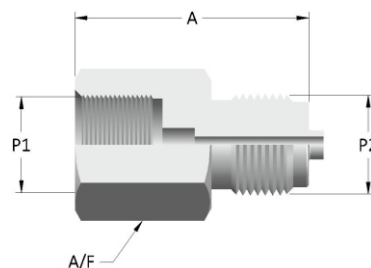

STANDARD CONFIGURATION DIMENSIONS

End Connection		Dimensions in mm		Dawsons-Tech Part No.
P1	P2	A	A/F	
1/4" BSP (Female)	1/2" BSP (Male)	33.0	22.0	FMGA-4RG-8G
1/2" BSP (Female)	1/4" BSP (Male)	43.0	27.0	FMGA-8RG-4G
1/2" BSP (Female)	1/2" NPT (Male)	45.0	27.0	FMGA-8RG-8N
1/2" NPT (Female)	1/2" BSP (Male)	50.0	27.0	FMGA-8N-8G

Dimensions are for reference only and are subject to change.

Male To Male Adapters

DAWSONS-TECH Male to Male Adapters are designed and manufactured to connect Female threads. Available in SS316 Material.

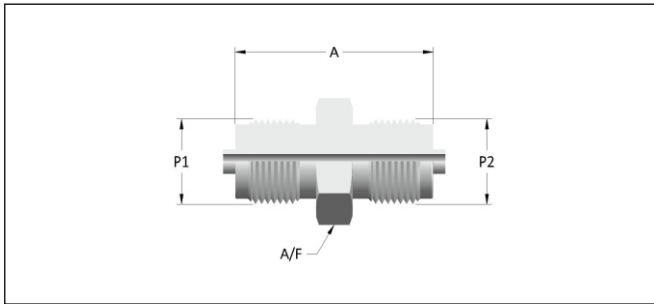

Male to Male Adapter (BSP to BSP)

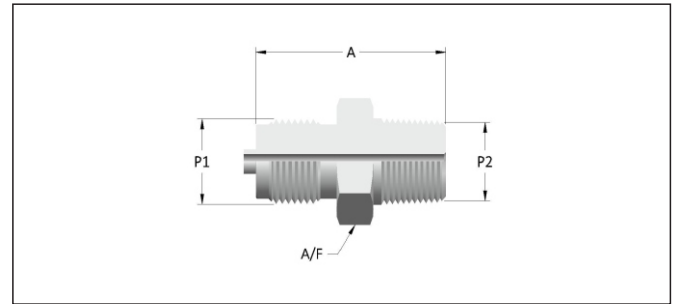

Male to Male Adapter (BSP to NPT)

STANDARD CONFIGURATION DIMENSIONS

End Connection		Dimensions in mm		Dawsons-Tech Part No.
P1	P2	A	A/F	
1/4" BSP	1/4" BSP	34.0	14.0	MMA-4G-4G
1/2" BSP	1/2" BSP	50.0	22.0	MMA-8G-8G
1/4" BSP	1/2" BSP	45.0	22.0	MMA-4G-8G
1/4" BSP	1/4" NPT	34.0	14.0	MMA-4G-4N
1/4" BSP	1/2" NPT	45.0	22.0	MMA-4G-8N
1/4" BSP	1/4" NPT	34.0	14.0	MMA-4N-4N
1/2" BSP	1/2" NPT	50.0	22.0	MMA-8N-8N

Dimensions are for reference only and are subject to change.

NOTE : Male to Male Adapters having length 76.2mm and 101.6mm are available on request.

Sealing Washer (EN837-1)

DAWSONS-TECH Sealing Washers are used for Parallel Male Thread in accordance with EN 837-1. Available in SS316 Material.

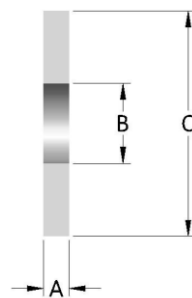

STANDARD CONFIGURATION DIMENSIONS

For Thread	Dimensions in mm			Dawsons-Tech Part No.
	A	B	C	
1/4" BSP	1.5	5.2	9.5	SW-4G
3/8" BSP	2.0	5.7	13.0	SW-6G
1/2" BSP	2.0	6.2	17.5	SW-8G
M20 X 1.5	2.0	6.2	17.5	SW-20M

Dimensions are for reference only and are subject to change.

Gauge Snubber

DAWSONS-TECH Gauge Snubbers are used to reduce the effect of pressure surges on the instrument and also to improve the output of the instrument. Available in SS316 Material.

Operating Parameters :

Pressure Rating : 6000 PSIG (413 Bar)

Temperature Rating : 60° C

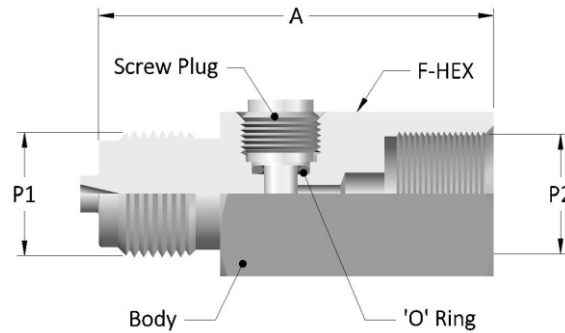

STANDARD CONFIGURATION DIMENSIONS

End Connection		Dimensions in mm		Dawsons-Tech Part No.
P1	P2	A	A/F	
1/4" BSP (Male)	1/4" BSP (Female)	61.0	27.0	SNB-4G
3/8" BSP (Male)	3/8" BSP (Female)	61.0	27.0	SNB-6G
1/2" BSP (Male)	1/2" BSP (Female)	61.0	27.0	SNB-8G
1/4" NPT (Male)	1/4" NPT (Female)	61.0	27.0	SNB-4N
1/2" NPT (Male)	1/2" NPT (Female)	61.0	27.0	SNB-8N
M20 x 1.5 (Male)	M20 x 1.5 (Female)	61.0	27.0	SNB-20M

Dimensions are for reference only and are subject to change.



Twin Ferrule Tube Fittings



Precision Thread / Weld Pipe Fittings



37° Flare / BSPP 60° Cone Fittings



**High Purity Metal Gasket
Face Seal Fittings**



**High Purity 'O' Ring
Face Seal Fittings**



High Purity Weld Fittings



Instrumentation / UHP Ball Valves



Instrumentation / UHP Check Valves



**Instrumentation
Needle / Gauge Valves**



**High Pressure Wellhead
Grease / Bleed Fittings**



Gauge Cock & Accessories



Quick Connect Couplings

NOTES : _____



Registered Office and Manufacturing Plant :

DAWSONS-TECH COMPONENTS LLP

Unit No. DD - 6 & 7, Khan Real Industrial Estate,

N. H. 08, Pelhar, Vasai Phata, Vasai (East),

Dist. Palghar - 401 208, Maharashtra, India.

Mobile : +91-9833355596

Email : info@dawsonstech.com

Website: www.dawsonstech.com

LLPIN: AAN-0434

Catalogue No. VGC-21